



### Description

Modern architectural luminaire HONEY R (round) features an original pattern of the simple form. HONEY R has the shape of a circle. HONEY R luminaire is designed to interiors that require demanding architectural solutions. It is perfect for hotel atriums, office receptions, architectural ateliers, conference rooms, corridors, halls in exclusive buildings and also cinemas, theatres or new-style shops in shopping centres

### Basic information

Family: **HONEY R**  
Product: **HONEY R N-ML PLX DALI WH 830 22 D900**  
Index: **BLS0000009475**  
Pictograms:



### Lighting and electrical parameters

Light source	LED
<b>Luminous flux LED [lm]</b>	<b>4265</b>
LED power [W]	32
<b>Luminaire luminous flux [lm]</b>	<b>2248</b>
Power of luminaire [W]	35
<b>Luminaire's light efficiency [lm/W]</b>	<b>64</b>
Color of the light [K]	3000
<b>CRI</b>	<b>&gt;80</b>
SDCM (LED sources)	3
<b>Photobiological risk class (IEC/EN 62471)</b>	<b>RG0</b>
Protection against electric shock	I
<b>Protection degree</b>	<b>IP54</b>
Voltage	220-240 V, 50-60 Hz
<b>Lifetime of LED sources [h]</b>	<b>60000</b>
Lx/By	L80/B10
<b>Operating temperature range [°C]</b>	<b>5 ÷ 30</b>
Driver	DALI Driver

### Mechanical parameters:

Assembly	ceiling mounted with magnets
<b>Material</b>	<b>aluminium</b>
Color	white
<b>Diffuser</b>	<b>PLX opalized</b>
Impact resistant	IK04
<b>Dimensions [mm]</b>	<b>Ø900 x 85</b>

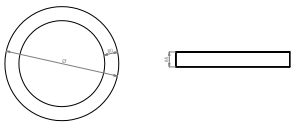

### A graph of light

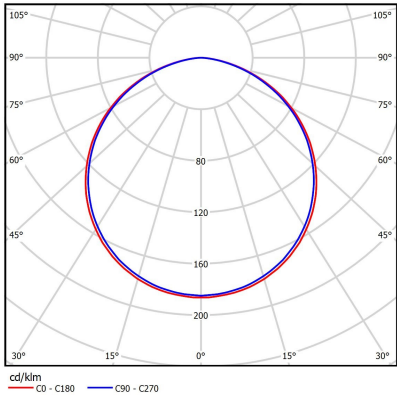

Technical data may be changed. Photos of the luminaires may differ from reality.

Date of last update: 25-04-2024