

Description

Outdoor luminaire MALLOW is made out of steel plate which is black powder-lacquered (RAL 9005). It is possible to install an emergency module with the thermostat to exploitation in low temperatures (-25°C). MALLOW luminaire can be placed on the wall or on the ceiling. It is recommended to light buildings' entrances, tunnels, undergrounds' entrances and other circulation areas.

Basic information

Family: **MALLOW MINI**
Product: **MALLOW MINI K PC IP65 BL 840 8 324**
Index: **BLS0000009241**
Pictograms:



Lighting and electrical parameters

Light source	LED
Luminous flux LED [lm]	1121
LED power [W]	5.5
Luminaire luminous flux [lm]	813
Power of luminaire [W]	7
Luminaire's light efficiency [lm/W]	116
Color of the light [K]	4000
CRI	>80
SDCM (LED sources)	2
Protection against electric shock	I
Protection degree	IP65
Voltage	220-240 V, 50-60 Hz
Lifetime of LED sources [h]	150000
Lx/By	L80/B50
Operating temperature range [°C]	-25÷30
Driver	LED Driver

Mechanical parameters:

Assembly	wall-mounted
Material	steel sheet
Color	black
Diffuser	PC opalized polycarbonate
Impact resistant	IK08
Dimensions [mm]	324 x 90 x 70

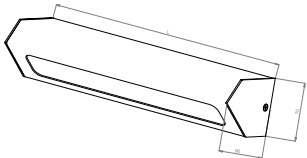

A graph of light

Technical data may be changed. Photos of the luminaires may differ from reality.

Date of last update: 25-04-2024