

### Description

Outdoor luminaire MALLOW is made out of steel plate which is black powder-lacquered (RAL 9005). It is possible to install an emergency module with the thermostat to exploitation in low temperatures (-25°C). MALLOW luminaire can be placed on the wall or on the ceiling. It is recommended to light buildings' entrances, tunnels, undergrounds' entrances and other circulation areas.

### Basic information

Family: **MALLOW MINI**  
Product: **MALLOW MINI K PC IP65 ANT 830 15 606**  
Index: **BLS0000009240**  
Pictograms:



### Lighting and electrical parameters

Light source	LED
<b>Luminous flux LED [lm]</b>	<b>2129</b>
LED power [W]	11
<b>Luminaire luminous flux [lm]</b>	<b>1544</b>
Power of luminaire [W]	13
<b>Luminaire's light efficiency [lm/W]</b>	<b>119</b>
Color of the light [K]	3000
<b>CRI</b>	<b>&gt;80</b>
SDCM (LED sources)	2
<b>Protection against electric shock</b>	<b>I</b>
Protection degree	IP65
<b>Voltage</b>	<b>220-240 V, 50-60 Hz</b>
Lifetime of LED sources [h]	150000
<b>Lx/By</b>	<b>L80/B50</b>
Operating temperature range [°C]	-25÷30
<b>Driver</b>	<b>LED Driver</b>

### Mechanical parameters:

Assembly	wall-mounted
<b>Material</b>	<b>steel sheet</b>
Color	anthracite
<b>Diffuser</b>	<b>PC opalized polycarbonate</b>
Impact resistant	IK08
<b>Dimensions [mm]</b>	<b>606 x 90 x 70</b>

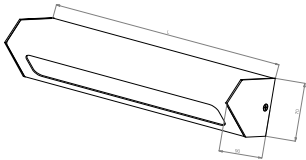

### A graph of light

Technical data may be changed. Photos of the luminaires may differ from reality.

Date of last update: 25-04-2024